

1

Section
SCALE: 1/4" = 1'-0"

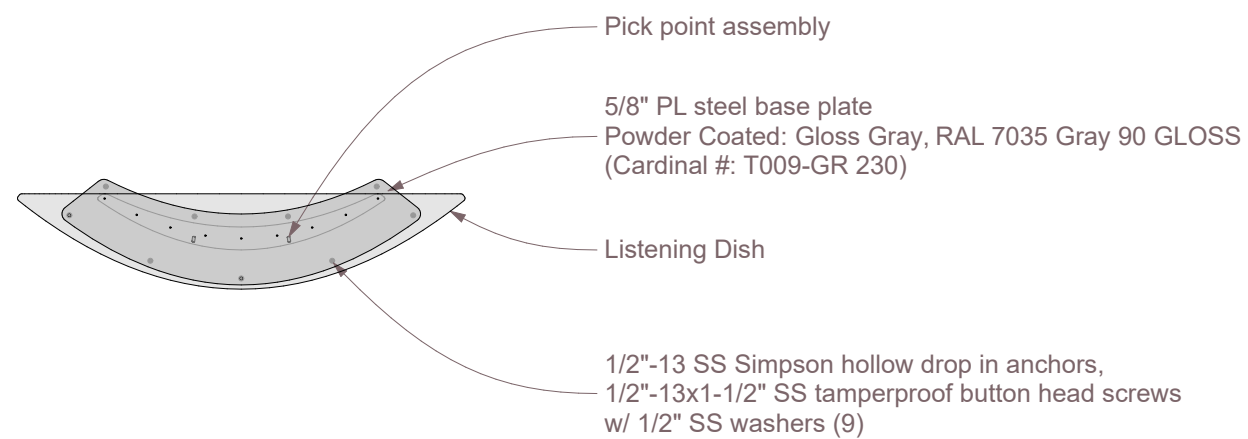

2

Plan
SCALE: 1/4" = 1'-0"



3

Listening Dish SC214-9



IDS SCULPTURE

PLAY. CLIMB. EXPLORE.

Listening Dish

SC214-9

Age Group: N/A

100% CONSTRUCTION DRAWINGS

All IDS projects are designed to meet or exceed ASTM 1487. Please consult ASTM 1487 for required hazard warning and signage specifications. Not all equipment may be appropriate for all children. Supervision is required. ASTM compliant safety surfacing is required under and around all play equipment. The Americans with Disabilities Act (ADA) may require your play area to be accessible, please consult with an ADA professional to ensure compliance.

Date **1/14/2025**

Sheet # **A.01.1**

Drawing Title
Layout

Approved By / Date:



IDS

591 South Boulevard Street
Gunnison, Colorado 81230
info@idsculpture.com

Note: pick points measured centerpoint on back surface of dish

Weight = 2,100 lbs

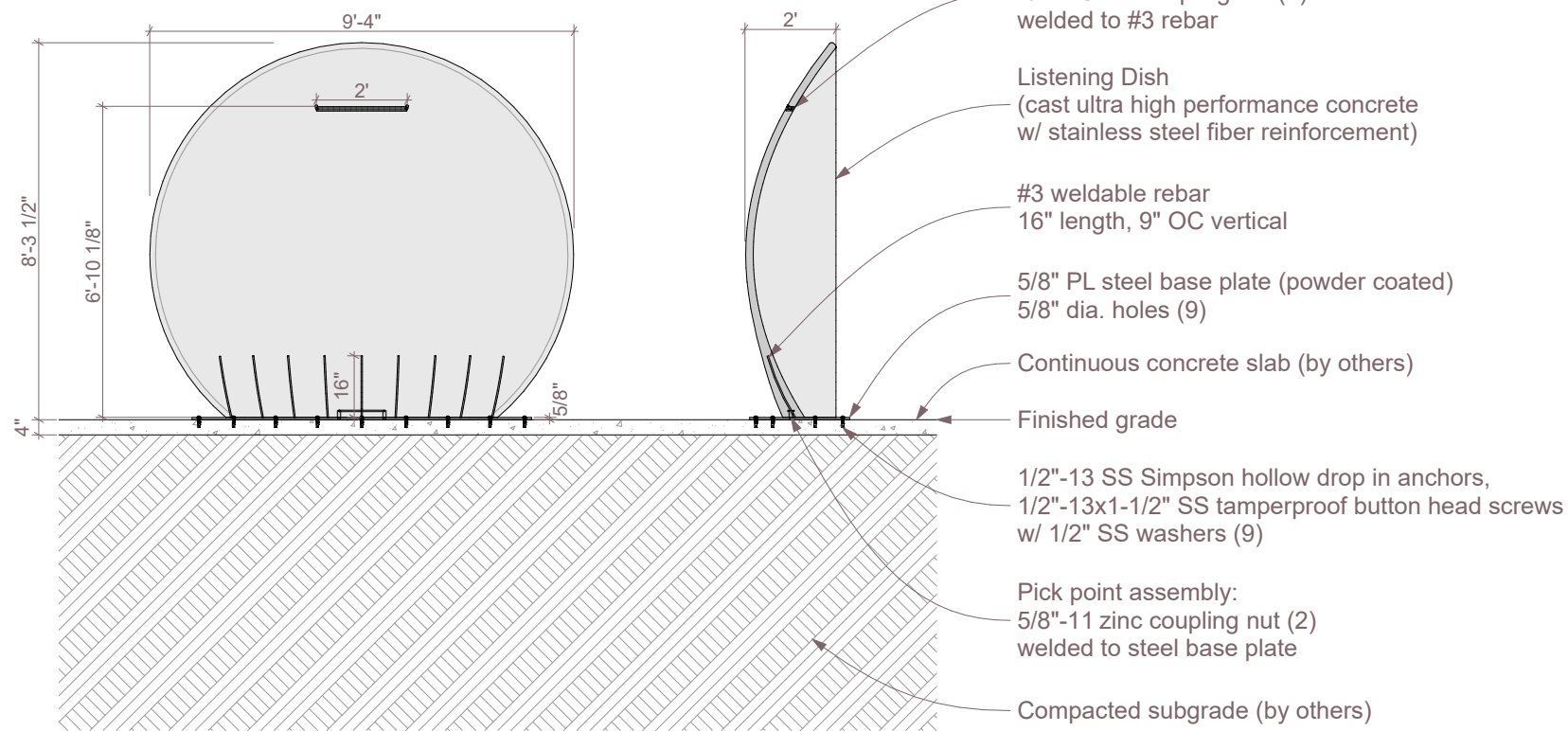

1

Section

SCALE: 1/4" = 1'-0"

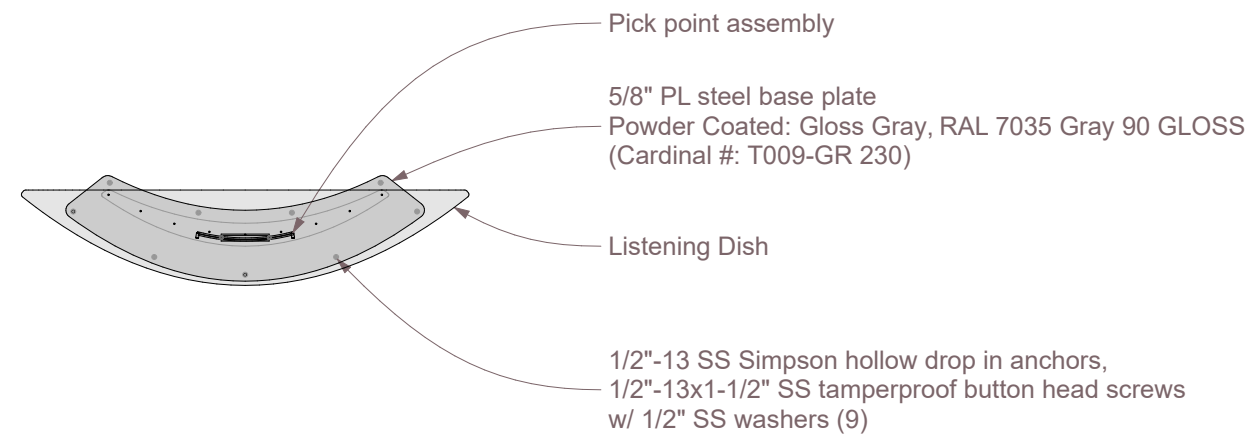

2

Plan

SCALE: 1/4" = 1'-0"



3

Listening Dish SC214-9



ID SCULPTURE

PLAY. CLIMB. EXPLORE.

Listening Dish

SC214-9

Age Group: N/A

100% CONSTRUCTION DRAWINGS

All IDS projects are designed to meet or exceed ASTM 1487. Please consult ASTM 1487 for required hazard warning and signage specifications. Not all equipment may be appropriate for all children. Supervision is required.

ASTM compliant safety surfacing is required under and around all play equipment. The Americans with Disabilities Act (ADA) may require your play area to be accessible, please consult with an ADA professional to ensure compliance.

Date **1/14/2025**

Sheet # **A.01.2**

Engineering Layout

Approved By / Date:



591 South Boulevard Street
Gunnison, Colorado 81230
info@idsculpture.com

IDS

Listening Dish

SC214-9

Age Group: N/A

100% CONSTRUCTION DRAWINGS

All IDS projects are designed to meet or exceed ASTM 1487. Please consult ASTM 1487 for required hazard warning and signage specifications. Not all equipment may be appropriate for all children. Supervision is required. ASTM compliant safety surfacing is required under and around all play equipment. The Americans with Disabilities Act (ADA) may require your play area to be accessible, please consult with an ADA professional to ensure compliance.

Date **1/14/2025**

Sheet # **A.01.3**

Drawing Title
Engineering Layout

Approved By / Date:

Pick point assembly:
1/2"-13 SS coupling nut (2)
structurally welded to #3 rebar
(2' horizontal rebar
10" vertical rebar)

Listening Dish
(cast with 5000 psi SCC mix
22" spread with fiber reinforcement)

#3 weldable rebar welded to steel
base plate
16" length, 9" OC vertical

5/8" PL steel base plate
(powder coated)
w/ 5/8" dia. holes (9)

1/2"-13 SS Simpson hollow
drop in anchors,
1/2"-13x1-1/2" SS tamperproof
button head screws,
w/ 1/2" SS washers (9)

Pick point assembly:
5/8"-11 zinc coupling nut (2)
welded to #3 rebar

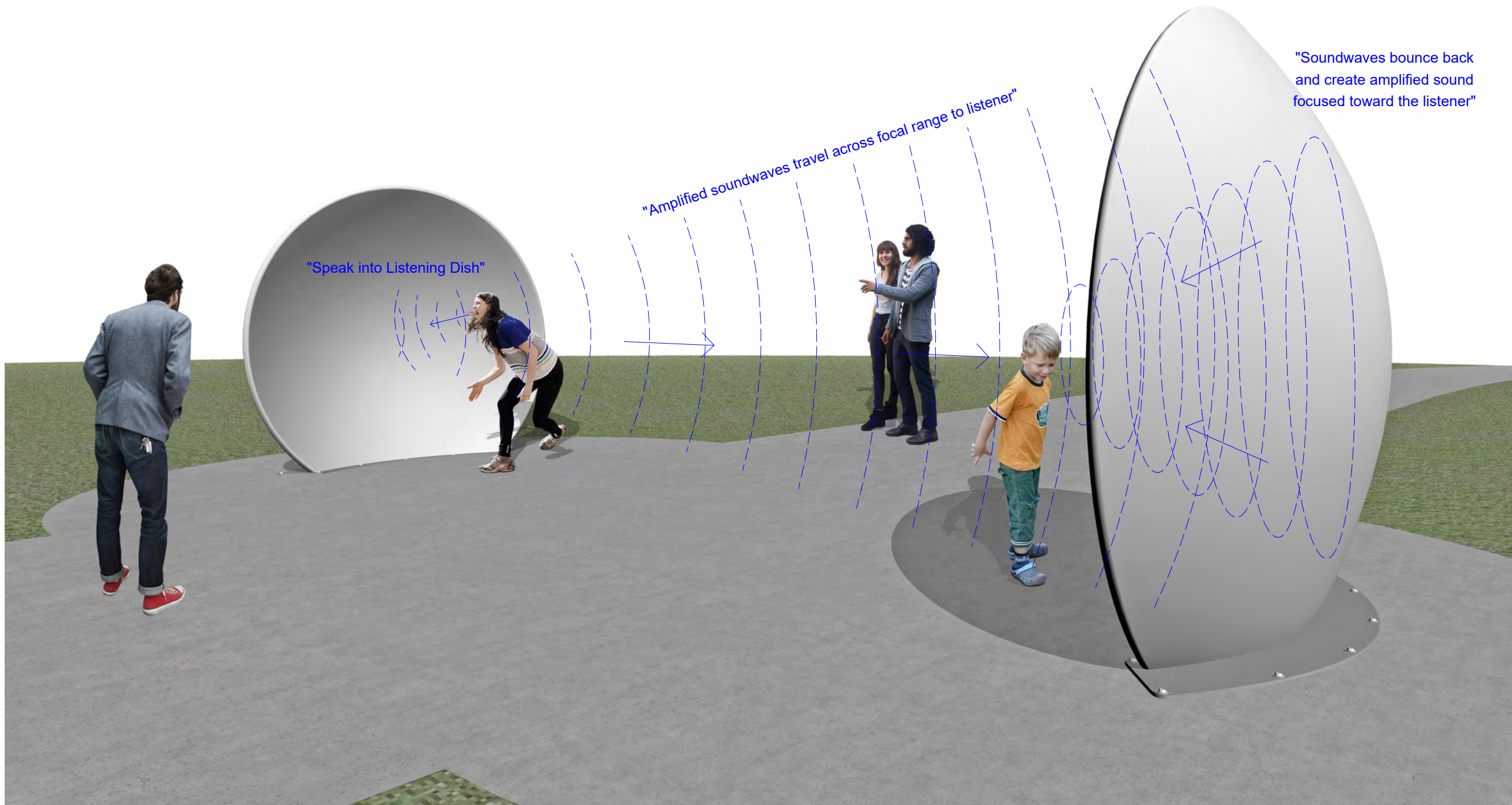

Listening Dish

SC214-9

Age Group: N/A

100% CONSTRUCTION DRAWINGS

All IDS projects are designed to meet or exceed ASTM 1487. Please consult ASTM 1487 for required hazard warning and signage specifications. Not all equipment may be appropriate for all children. Supervision is required. ASTM compliant safety surfacing is required under and around all play equipment. The Americans with Disabilities Act (ADA) may require your play area to be accessible, please consult with an ADA professional to ensure compliance.

Date **1/14/2025**

Sheet # **A.01.4**

Drawing Title
Diagram

Approved By / Date:

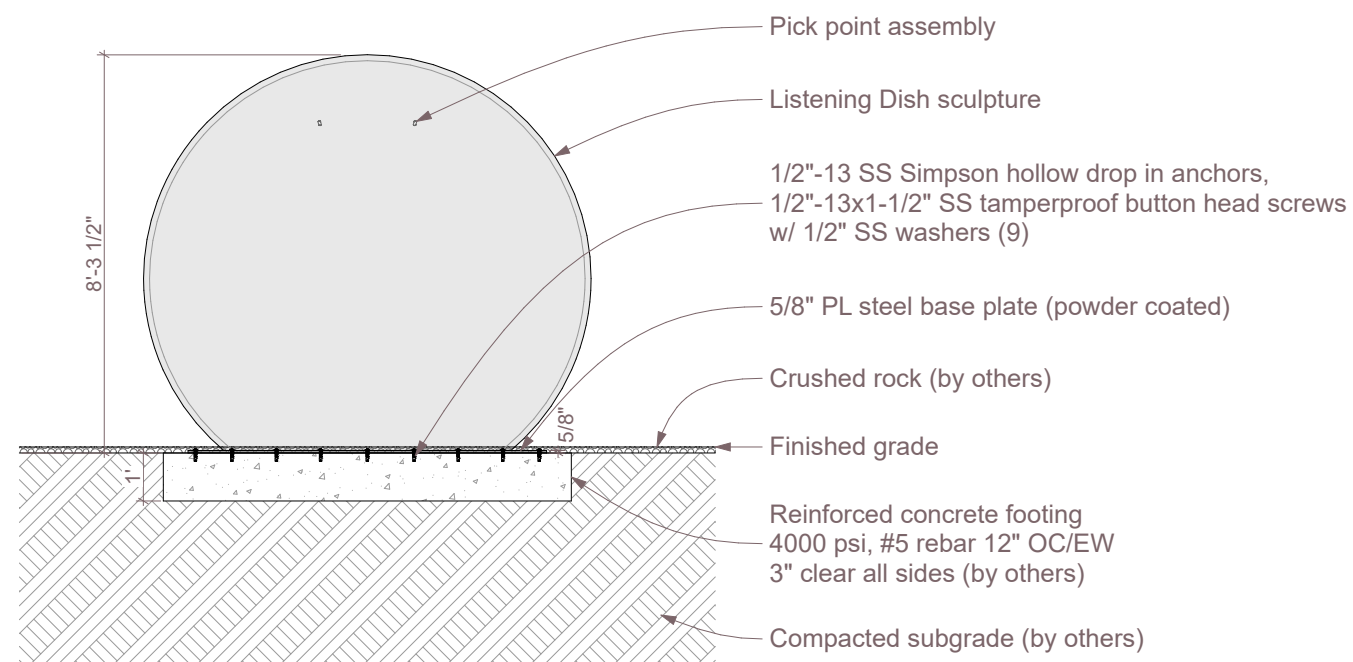

1

Section
SCALE: 1/4" = 1'-0"

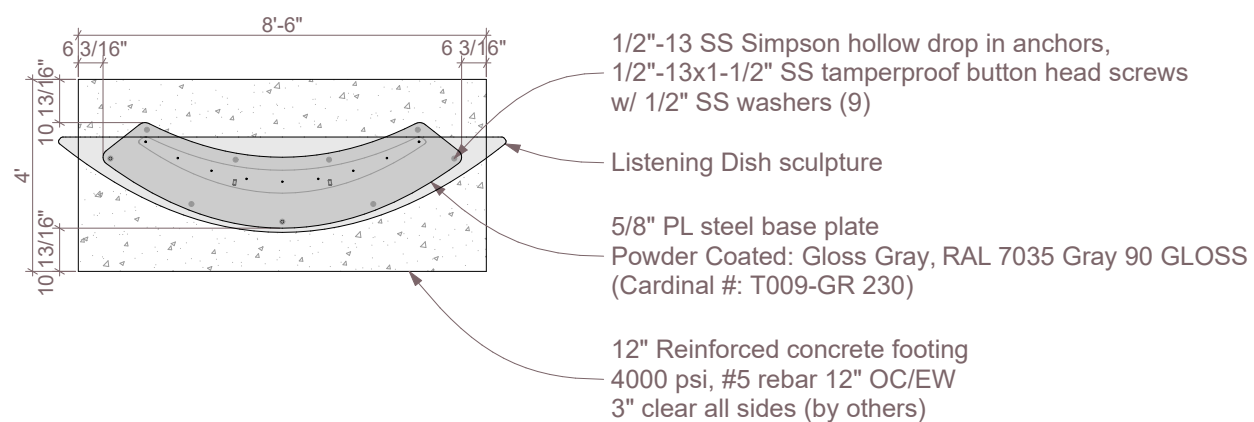

2

Plan
SCALE: 1/4" = 1'-0"



3

Listening Dish SC214-9



IDS SCULPTURE

PLAY. CLIMB. EXPLORE.

Listening Dish

SC214-9

Age Group: N/A

100% CONSTRUCTION DRAWINGS

All IDS projects are designed to meet or exceed ASTM 1487. Please consult ASTM 1487 for required hazard warning and signage specifications. Not all equipment may be appropriate for all children. Supervision is required.

ASTM compliant safety surfacing is required under and around all play equipment. The Americans with Disabilities Act (ADA) may require your play area to be accessible, please consult with an ADA professional to ensure compliance.

Date **1/14/2025**

Sheet # **A.01.5**

Drawing Title
Layout w/ Spread Footer

Approved By / Date:



591 South Boulevard Street
Gunnison, Colorado 81230
info@idsculpture.com